

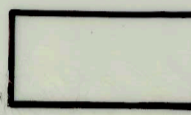

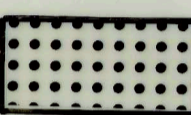
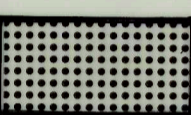

ROME TOWNSHIP

OFFICIAL ZONING MAP OF ROME TOWNSHIP

LEGEND

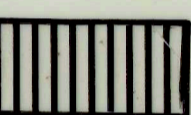
-  AG DISTRICT: Agricultural
-  R-1 DISTRICT: Single Family Residential
-  R-2 DISTRICT: Single Family Residential
-  RMH DISTRICT: Mobile Home Park
-  C DISTRICT: Commercial
-  I DISTRICT: Industrial

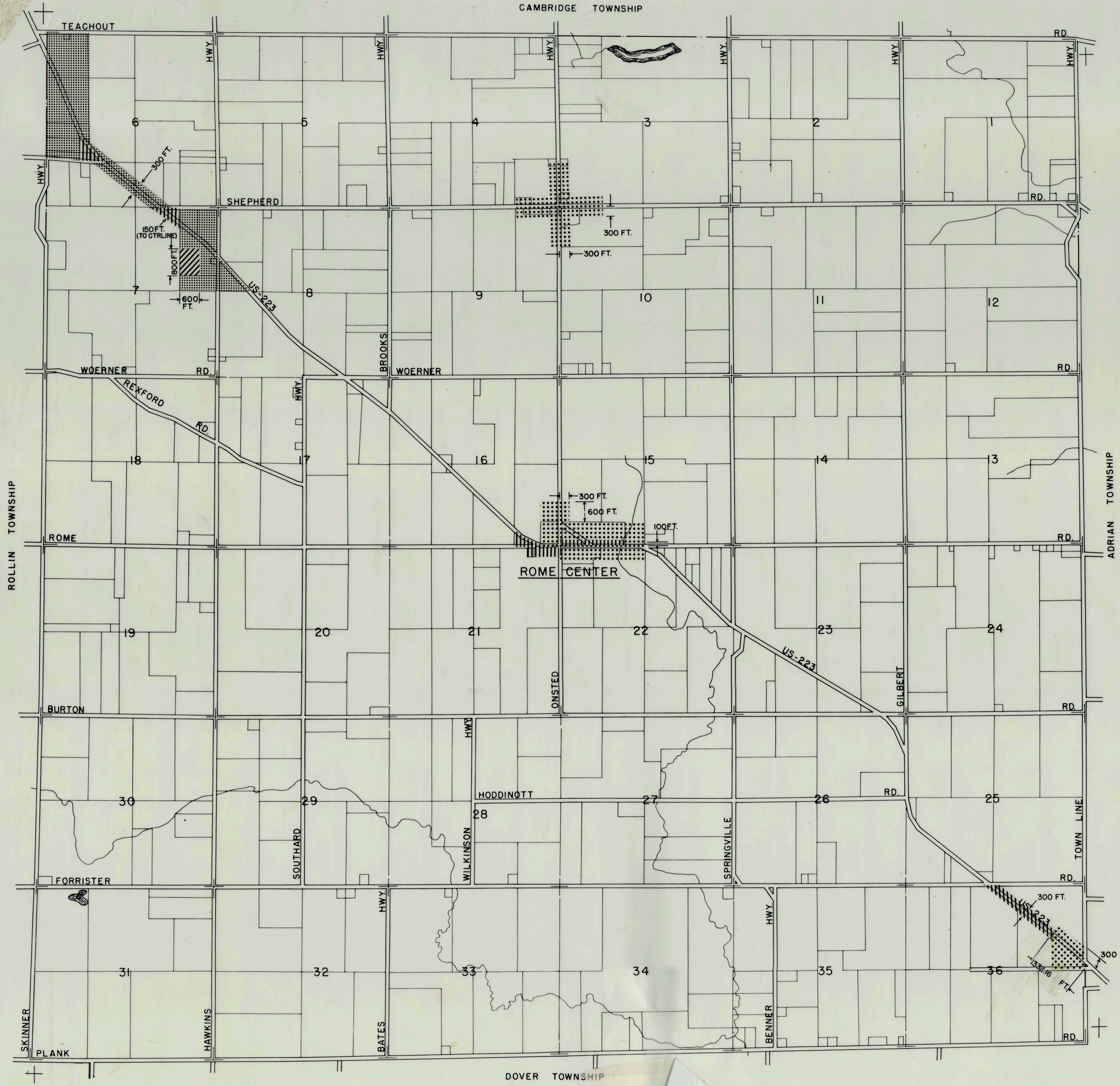

REGION
PLANNING COMMISSION
JACKSON COUNTY BUILDING (517) 7873800

SCALE IN FEET
0 1200 2400 3600 4800
LENAWEE COUNTY, MICHIGAN
FEBRUARY 1974

CERTIFICATION
This is to certify that this is the Official Zoning Map referred to in the Zoning Ordinance of Rome Township adopted on _____
TOWNSHIP SUPERVISOR _____ DATE _____
TOWNSHIP CLERK _____ DATE _____
REVISED _____